



City of Westminster

Item No:

Date:

Licensing Ref No:

Title of Report:

Report of:

Wards involved:

Policy context:

Financial summary:

Report Author:

Contact details

Licensing Sub-Committee Report

9 May 2024

24/01009/LIPN - New Premises Licence

16 Henrietta Street
London
WC2E 8QH

Director of Public Protection and Licensing

St James's

City of Westminster Statement of Licensing Policy

None

Roxsana Haq
Senior Licensing Officer

Telephone: 020 7641 6500
Email: rhaq@westminster.gov.uk

1. Application

1-A Applicant and premises			
Application Type:	New Premises Licence, Licensing Act 2003		
Application received date:	21 February 2024		
Applicant:	(1) Capital & Counties CG Limited And (2) Capital & Counties CG Nominee Limited		
Premises:	TBC		
Premises address:	16 Henrietta Street London WC2E 8QH	Ward:	St James's
		Cumulative Impact Area:	West End CIZ
		Special Consideration Zone:	None.
Premises description:	This application is made by the landlord of the premises which used to operate as a restaurant. The previous licensee (tenant) has gone into insolvency.		
Premises licence history:	There was a previous licence in place which has since lapsed. A copy of this licence (23/09243/LIPDPS) is shown at Appendix 3 .		
Applicant submissions:	Mediation communication from the applicant to the interested parties can be seen at Appendix 2 .		
Applicant amendments:	None.		

1-B Proposed licensable activities and hours							
Late Night Refreshment:				Indoors, outdoors or both			Indoors
Day:	Mon	Tues	Wed	Thur	Fri	Sat	Sun
Start:	23:00	23:00	23:00	23:00	23:00	23:00	23:00
End:	00:30	00:30	00:30	00:30	00:30	00:30	00:00
Seasonal variations/ Non-standard timings:			From the end of permitted hours on New Year's Eve to the start of permitted hours on New Year's Day.				
Recorded music			Indoors, outdoors or both				Indoors
Day:	Mon	Tues	Wed	Thur	Fri	Sat	Sun
Start:	23:00	23:00	23:00	23:00	23:00	23:00	23:00
End:	00:30	00:30	00:30	00:30	00:30	00:30	00:00
Seasonal variations/ Non-standard timings:			From the end of permitted hours on New Year's Eve to the start of permitted hours on New Year's Day.				
Sale by retail of alcohol				On or off sales or both:			Both
Day:	Mon	Tues	Wed	Thur	Fri	Sat	Sun
Start:	10:00	10:00	10:00	10:00	10:00	10:00	12:00
End:	00:00	00:00	00:00	00:00	00:00	00:00	23:30
Seasonal variations/ Non-standard timings:			From the end of permitted hours on New Year's Eve to the start of permitted hours on New Year's Day.				

Hours premises are open to the public							
Day:	Mon	Tues	Wed	Thur	Fri	Sat	Sun
Start:	10:00	10:00	10:00	10:00	10:00	10:00	12:00
End:	00:30	00:30	00:30	00:30	00:30	00:30	00:00
Seasonal variations/ Non-standard timings:		From the end of permitted hours on New Year's Eve to the start of permitted hours on New Year's Day.					
Adult Entertainment:		None.					

2. Representations

2-A Responsible Authorities

Responsible Authority:	Environmental Health Service
Representative:	Kudzy Mondhlani
Received:	13th March 2024 (<i>withdrawn 27th March 2024</i>)

I refer to the application to reinstate a lapsed Premises Licence reference 23/09243/LIPDPS.

The premises are located within the West End Cumulative Impact Zone as stated in the City of Westminster's Statement of Licensing Policy. The applicant has submitted floor plans of the ground and basement floors dated 13 November 2015.

The applicant is seeking the following:

1. To provide for the Supply of Alcohol both 'On' and 'Off' the premises Monday to Saturday between 10:00 and 00:00 and Sunday between 12:00 and 23:30 hours. From the end of permitted hours on New Year's Eve to the start of permitted hours on New Year's Day.
2. To provide Recorded Music 'indoors' Monday to Saturday between 23:00 and 00:30 and Sunday between 23.00 and 00:00 hours. From the end of permitted hours on New Year's Eve to the start of permitted hours on New Year's Day.
3. To provide Late Night Refreshment 'Indoors' Monday to Saturday between 23:00 and 00:30 hours Sunday between 23.00 and 00:00 hours. From the end of permitted hours on New Year's Eve to the start of permitted hours on New Year's Day.

I wish to make the following representation:

1. The supply of alcohol may have the likely effect of causing an increase in Public Nuisance in the West End CIZ and may also impact on Public Safety.
2. The provision of recorded music may have the likely effect of causing an increase in Public Nuisance in the West End CIZ and may also impact on Public Safety.
3. The provision of late-night refreshment may have the likely effect of causing an increase in Public Nuisance in the West End CIZ and impact on Public Safety.

The granting of the application as presented would have the likely effect of causing an increase in Public Nuisance and impact on Public Safety within the West End CIZ. A site visit is required to assess the changes. The applicant has provided additional information with the application which is being considered.

Should you wish to discuss the matter further please do not hesitate to contact me.

On 27th March 2024 Environmental Health submitted the following and withdrew their objection:

"Having considered the application further and noted that it mirrors that of a licence lapsed due to insolvency, and that there were no noise issues at the premises whilst it traded, I can confirm that EH are withdrawing representation."

2-B Other Persons

Name:	[REDACTED]		
Address and/or Residents Association:	[REDACTED] [REDACTED] [REDACTED] [REDACTED]		
Status:	Valid	In support or objection:	OBJECTION
Received:	1 Mar 2024		

I am writing to formally object to the proposed extension of alcohol licensing hours near the property I own on [REDACTED]. As an adjacent property owner, I am deeply concerned about the potential negative impact that an extension of alcohol licensing hours could have on the safety, tranquillity, and value of my property.

Furthermore, extending alcohol licensing hours in close proximity to residential areas may exacerbate existing challenges related to public intoxication, underage drinking, and the overall well-being of community members, particularly those residing in or around the property.

In consideration of the welfare of the residents and the harmonious coexistence of commercial and residential zones, I urge you to carefully review and reconsider the proposal to extend alcohol licensing hours. It is imperative to prioritize the needs and interests of property owners and residents alike, ensuring that any decisions made align with the values of safety, peace, and respect for residential and commercial properties.

I respectfully request that my objection be taken into account during the decision-making process regarding the proposed extension of alcohol licensing hours.

Name:	[REDACTED]		
Address and/or Residents Association:	[REDACTED] [REDACTED] [REDACTED] [REDACTED]		
Status:	Valid	In support or objection:	OBJECTION
Received:	29 Feb 2024		

A nearby premises, Miss Riot, also on that side of Henrietta Street has become an incredible noise nuisance playing loud club music late into the night on Friday, Saturday and sometimes Sunday nights. I missed the opportunity to comment then, but the idea of another premises on a residential street with a late alcohol & music playback license 7 days a week until midnight most days (which will undoubtedly be pushed later despite the letter of the license) is going to make the street even less habitable for all the neighbours. please reconsider such late licensing, especially for loud music.

3. Policy & Guidance

The following policies within the City of Westminster Statement of Licensing Policy apply:	
<p>Cumulative Impact Policy CIP1 applies:</p>	<p>A. It is the Licensing Authority’s policy to refuse applications within the West End Cumulative Impact Zone for: pubs and bars, fast food premises, and music and dancing and similar entertainment, other than applications to:</p> <ol style="list-style-type: none"> 1. Vary the hours within Core Hours under Policy HRS1, and/or 2. Vary the licence to reduce the overall capacity of the premises. <p>C. Applications for other premises types within the West End Cumulative Impact Zones will be subject to other policies within this statement and must demonstrate that they will not add to cumulative impact.</p> <p>D. For the purposes of this policy the premises types referred to in Clause A are defined within the relevant premises use policies within this statement.</p>
<p>Hours Policy HRS1 applies</p>	<p>A. Applications within the core hours set out below in this policy will generally be granted for the relevant premises uses, subject to not being contrary to other policies in the Statement of Licensing Policy.</p> <p>B. Applications for hours outside the core hours set out in Clause C will be considered on their merits, subject to other relevant policies, and with particular regard to the following:</p> <ol style="list-style-type: none"> 1. The demonstration of compliance in the requirements of policies CD1, PS1, PN1 and CH1 associated with the likelihood of the effect of the grant of a licence for later or earlier hours on crime and disorder, public safety, public nuisance and the protection of children from harm. 2. If the application is located within a Special Consideration Zone they have demonstrated that they have taken account of the issues identified in that area and provided adequate mitigation. 3. Whether there is residential accommodation in the proximity of the premises that would likely be adversely affected by premises being open or carrying out operations at the hours proposed. 4. The proposed hours of the licensable activities and when customers will be permitted to remain on the premises. 5. The proposed hours when any music, including incidental music, will be played. 6. The hours when customers will be allowed to take food or drink outside the premises or be within open areas which form part of the premises. 7. The existing hours of licensable activities and the past operation of the premises (if any) and hours of licensable premises in the vicinity. 8. Whether customers and staff have adequate access to public transport when arriving at and leaving the premises, especially at night. 9. The capacity of the premises. 10. The type of use, recognising that some venues are more likely to impact the licensing objectives than others; for example, pubs and bars are higher risk than theatres, cinemas and other cultural and sporting venues due to the nature of the operation. 11. The Licensing Authority will take into account the active measures proposed for a ‘winding down’ period including arrangements for people to be collected from the premises to travel home safely. 12. Conditions on hours may be attached that require that the supply of

	<p>alcohol for consumption on the premises ceases a suitable period of time before customers are required to leave the premises.</p> <p>13. The council, acting as the Licensing Authority, may reduce hours if, after review, it is necessary to impose conditions specifying shorter hours in order to promote the licensing objectives.</p> <p>14. Specific days for non-standard hours should be identified and justified as part of the application to allow responsible authorities and interested parties to evaluate the impact that these licensable activities may have, and to plan accordingly. The consideration of applications for later hours for Bank Holiday Mondays will take into account that later hours are generally granted for preceding Sundays and that the next day is a working day. Non-specific days are expected to be covered by Temporary Event Notices or variation applications.</p> <p>C. For the purpose of Clauses A and B above, the Core Hours for applications for each premises use type as defined within this policy are:</p> <p>8. Restaurants Monday to Thursday: 9am to 11.30pm. Friday and Saturday: 9am to Midnight. Sunday: 9am to 10.30pm. Sundays immediately prior to a bank holiday: 9am to Midnight.</p> <p>D. Core hours are when customers are permitted to be on the premises and therefore the maximum opening hours permitted will be to the same start and terminal hours for each of the days where licensable activity is permitted.</p> <p>E. For the purposes of this policy, 'premises uses' are defined within the relevant premises use policies within this statement.</p> <p>Note: The core hours are for all licensable activities but if an application includes late night refreshment, then the starting time for that licensable activity will be 11pm.</p>
<p>Restaurant Policy RNT1 applies</p>	<p>B. Applications inside the West End Cumulative Impact Zone will generally be granted subject to:</p> <ol style="list-style-type: none"> 1. The application meeting the requirements of policies CD1, PS1, PN1 and CH1. 2. The hours for licensable activities being within the council's Core Hours Policy HRS1. 3. The operation of any delivery services for alcohol and/or late night refreshment meeting the council's Ancillary Delivery of Alcohol and/or Late-Night Refreshment Policy DEL1. 4. The applicant has taken account of the Special Consideration Zones Policy SCZ1 if the premises are located within a designated zone. 5. The application and operation of the venue meeting the definition of a restaurant as per Clause C. <p>C. For the purposes of this policy a restaurant is defined as:</p> <ol style="list-style-type: none"> 1. A premises in which customers are shown to their table or the customer will select a table themselves to which food is either served to them or they have collected themselves. 2. Which provide food in the form of substantial table meals that are prepared on the premises and are served and consumed at a table.

	<p>3. Which do not provide any takeaway service of food and/or drink for immediate consumption, except if provided via an ancillary delivery service to customers at their residential or workplace address.</p> <p>4. Where alcohol shall not be sold, supplied, or consumed on the premises otherwise than to persons who are bona fide taking substantial table meals and provided always that the consumption of alcohol by such persons is ancillary to taking such meals.</p> <p>5. The sale and consumption of alcohol prior to such meals may be in a bar area but must also be ancillary to the taking of such meal.</p>
--	---

4. Equality Implications

The Council in its capacity as Licensing Authority has a duty to have regard to its public sector equality duty under section 149 of the Equality Act 2010. In summary, section 149 provides that a Public Authority must, in the exercise of its functions, have due regard to the need to:

- (a) eliminate discrimination harassment, victimisation and any other conduct that is prohibited by or under this Act;
- (b) advance equality of opportunity between persons who share a relevant protected characteristic and persons who do not share it; and
- (c) foster good relations between persons who share a relevant protected characteristics and persons who do not share it.

Section 149 (7) of the Equality Act 2010 defines the relevant protected characteristics as age, disability, gender reassignment, marriage and civil partnership, pregnancy and maternity, race, religion or belief, sex, and sexual orientation.

5. Appendices

Appendix 1	Premises plans
Appendix 2	Applicant supporting documents
Appendix 3	Premises history
Appendix 4	Proposed conditions
Appendix 5	Residential map and list of premises in the vicinity

Report author:	Miss Roxsana Haq Senior Licensing Officer
Contact:	Telephone: 020 7641 6500 Email: rhaq@westminster.gov.uk

If you have any queries about this report or wish to inspect one of the background papers please contact the report author.

Background Documents – Local Government (Access to Information) Act 1972

1	Licensing Act 2003	N/A
2	City of Westminster Statement of Licensing Policy	01 October 2021
3	Amended Guidance issued under section 182 of the Licensing Act 2003	December 2023
4	Cumulative Impact Assessment	04 December 2023
5	Environmental Health Service Representation	13 March 2024
6	Interested Party representation (1)	1 March 2024
7	Interested Party representation (2)	29 February 2024

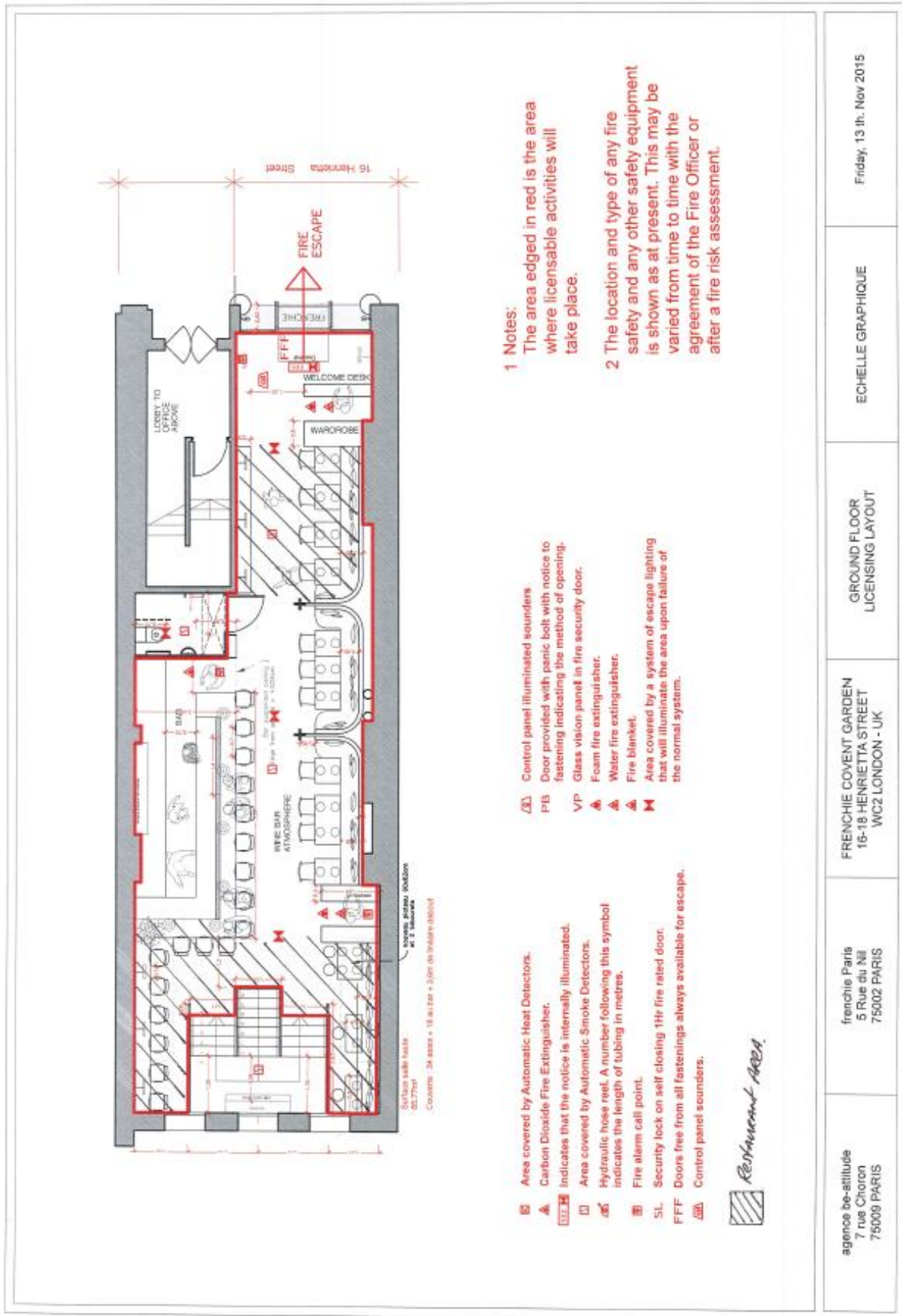

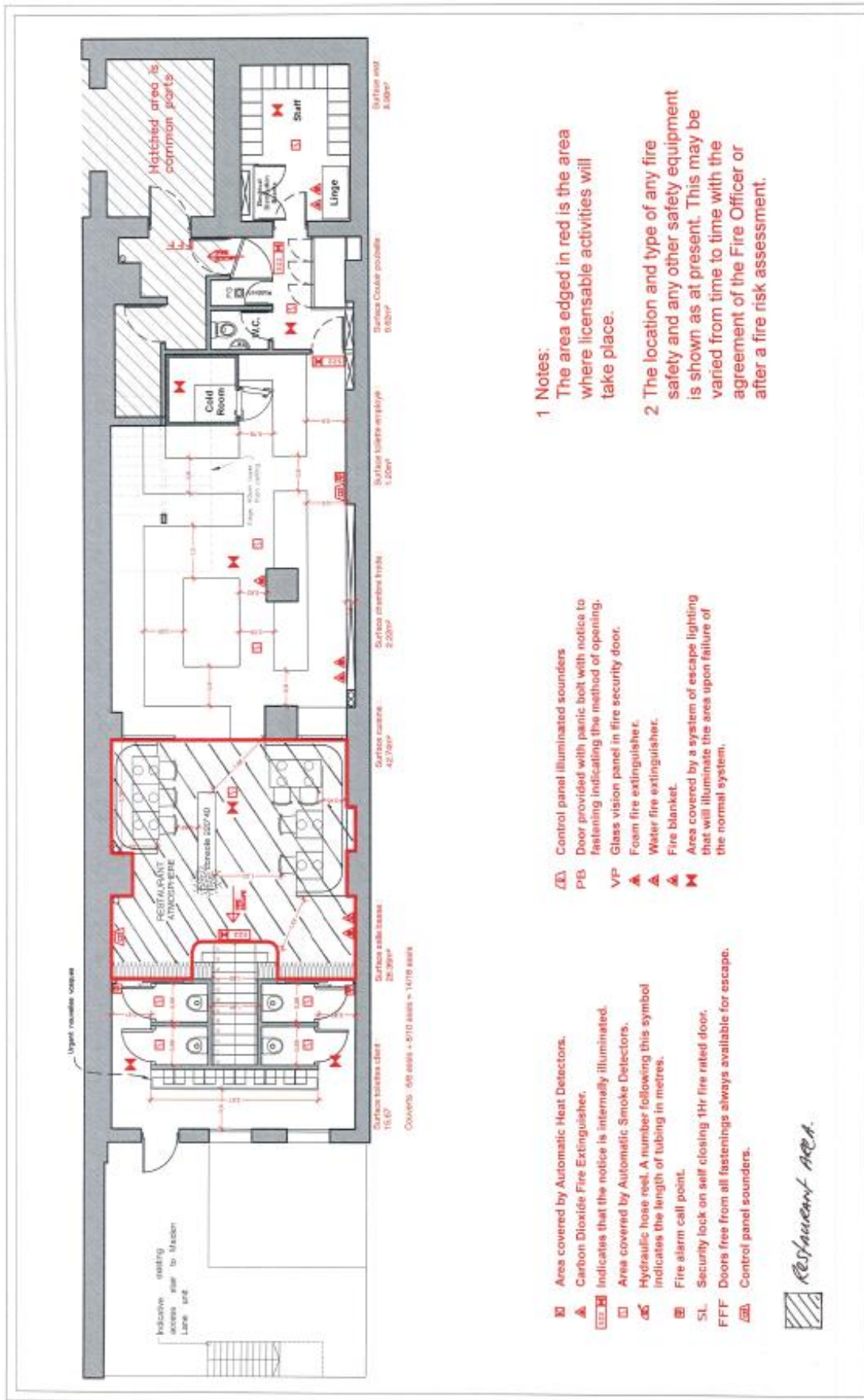

1 Notes:

The area edged in red is the area where licensable activities will take place.

The location and type of any fire safety and any other safety equipment is shown as at present. This may be varied from time to time with the agreement of the Fire Officer or after a fire risk assessment.

- ☒ Control panel illuminated sounders
- PB Door provided with panic bolt with notice to fastening indicating the method of opening.
- VP Glass vision panel in fire security door.
- ▲ Foam fire extinguisher.
- ▲ Water fire extinguisher.
- ▲ Fire blanket.
- ☒ Area covered by a system of escape lighting that will illuminate the area upon failure of the normal system.

- ☒ Area covered by Automatic Heat Detectors.
- ▲ Carbon Dioxide Fire Extinguisher.
- ☒ Indicates that the notice is internally illuminated.
- ☒ Area covered by Automatic Smoke Detectors.
- ☒ Hydraulic hose reel. A number following this symbol indicates the length of tubing in metres.
- ☒ Fire alarm call point.
- SL Security lock on self closing 1Hr fire rated door.
- FFF Doors free from all fastenings always available for escape.
- ☒ Control panel sounders.

Restaurant AREA

<p>agence be-attitude 7 rue Choron 75009 PARIS</p>	<p>FRENCHIE COVENT GARDEN 16-18 HENRIETTA STREET WC2 LONDON - UK</p>	<p>BASEMENT LICENSING LAYOUT</p>	<p>ECHELLE GRAPHIQUE</p> <p>Friday, 13 th, Nov 2015</p>
--	--	--------------------------------------	---

Applicant Supporting Documents

Appendix 2

The following message emailed via the Licensing Service to address both the residents by the applicant.

Email text to interested parties (via separate emails):

Dear [REDACTED]

We hope this email finds you well.

We act for Shaftesbury Capital (formerly Capco) in respect of their premises licence application to effectively re-instate the lapsed Frenchie restaurant licence on the same terms. Our client owns the building and was Frenchie's landlord until the restaurant closed earlier this year.

Westminster Council have provided us with a copy of your comments in respect of the application. Thank you for taking the time to provide your feedback. We would be grateful for your consideration of this email, which we hope will help to clarify the limited extent of our client's proposals.

For the avoidance of any doubt, our client is not applying for a new licensed premises on Henrietta Street or any extension to hours. The application simply seeks to effectively re-instate the former Frenchie restaurant licence on the exact same terms. The application is required because the Frenchie licence lapsed following the restaurant business going into administration.

The proposed hours and conditions are the same as the Frenchie licence, including conditions requiring restaurant use. Our client submitted the application to ensure that there remains an appropriately conditioned licence in place to transfer to an incoming restaurant operator.

We hope that this helps to clarify and address the concerns that you have raised.

Please do not hesitate to contact us if you have any further queries arising.

Thank you very much indeed.

Best wishes

Jack Spiegler
Partner
Thomas & Thomas Partners LLP
38a Monmouth Street
London WC2H 9EP

Previous lapsed licence:



City of Westminster
64 Victoria Street, London, SW1E 6QP

Schedule 12
Part A

WARD: St James's
UPRN: 010033551344

Premises licence

Regulation 33, 34

Premises licence number:

23/09243/LIPDPS

Original Reference:

15/03912/LIPN

Part 1 – Premises details

Postal address of premises:

Frenchie
Basement And Ground Floor
16 Henrietta Street
London
WC2E 8QH

Telephone Number: Not Supplied

Where the licence is time limited, the dates:

Not applicable

Licensable activities authorised by the licence:

Playing of Recorded Music
Late Night Refreshment
Sale by Retail of Alcohol

The times the licence authorises the carrying out of licensable activities:

Playing of Recorded Music

Monday to Saturday: 23:00 to 00:30
Sunday: 23:00 to 00:00

Non-standard Timings: From the end of permitted hours on New Year's Eve to the start of permitted hours on New Year's Day.

Late Night Refreshment

Monday to Saturday: 23:00 to 00:30
Sunday: 23:00 to 00:00

Non-standard Timings: From the end of permitted hours on New Year's Eve to the start of permitted hours on New Year's Day.

Sale by Retail of Alcohol

Monday to Saturday: 10:00 to 00:00
Sunday: 12:00 to 23:30

Non-standard Timings: From the end of permitted hours on New Year's Eve to the start of permitted hours on New Year's Day.

For times authorised for Christmas, New Year and Good Friday see conditions at Annex 1

The opening hours of the premises:

Monday to Saturday: 10:00 to 00:30
Sunday: 12:00 to 00:00

Where the licence authorises supplies of alcohol, whether these are on and/or off supplies:

Alcohol is supplied for consumption both on and off the Premises.

Part 2

Name, (registered) address, telephone number and email (where relevant) of holder of premises licence:

Frenchie London Ltd
C/O Pbsl
First Floor
42 Sydenham Road
London
SE26 5QF

Registered number of holder, for example company number, charity number (where applicable)

09627718

Name, address and telephone number of designated premises supervisor where the premises licence authorises the supply of alcohol:

Name: Ben Wesley Matthews

Please note: It is the policy of the Licensing Authority not to display the address details of a designated premises supervisor.

Personal licence number and issuing authority of personal licence held by designated premises supervisor where the premises licence authorises for the supply of alcohol:

Licence Number: 049319
Licensing Authority: Luton Borough Council

Date: 11th January 2024

Signed:



pp

This licence has been authorised by Karyn Abbott on behalf of the Director - Environment, Climate & Public Protection (ECPP).

Annex 1 – Mandatory conditions

1. No supply of alcohol may be made at a time when there is no designated premises supervisor in respect of this licence.
2. No supply of alcohol may be made at a time when the designated premises supervisor does not hold a personal licence or the personal licence is suspended.
3. Every supply of alcohol under this licence must be made or authorised by a person who holds a personal licence.
4. (1) The responsible person must ensure that staff on relevant premises do not carry out, arrange or participate in any irresponsible promotions in relation to the premises.

(2) In this paragraph, an irresponsible promotion means any one or more of the following activities, or substantially similar activities, carried on for the purpose of encouraging the sale or supply of alcohol for consumption on the premises
 - (a) games or other activities which require or encourage, or are designed to require or encourage, individuals to;
 - (i) drink a quantity of alcohol within a time limit (other than to drink alcohol sold or supplied on the premises before the cessation of the period in which the responsible person is authorised to sell or supply alcohol), or
 - (ii) drink as much alcohol as possible (whether within a time limit or otherwise);
 - (b) provision of unlimited or unspecified quantities of alcohol free or for a fixed or discounted fee to the public or to a group defined by a particular characteristic in a manner which carries a significant risk of undermining a licensing objective;
 - (c) provision of free or discounted alcohol or any other thing as a prize to encourage or reward the purchase and consumption of alcohol over a period of 24 hours or less in a manner which carries a significant risk of undermining a licensing objective;
 - (d) selling or supplying alcohol in association with promotional posters or flyers on, or in the vicinity of, the premises which can reasonably be considered to condone, encourage or glamorise anti-social behaviour or to refer to the effects of drunkenness in any favourable manner;
 - (e) dispensing alcohol directly by one person into the mouth of another (other than where that other person is unable to drink without assistance by reason of a disability).
5. The responsible person must ensure that free potable water is provided on request to customers where it is reasonably available.
6. (1) The premises licence holder or club premises certificate holder must ensure that an age verification policy is adopted in respect of the premises in relation to the sale or supply of alcohol.

(2) The designated premises supervisor in relation to the premises licence must ensure that the supply of alcohol at the premises is carried on in accordance with the age verification policy.

(3) The policy must require individuals who appear to the responsible person to be under 18 years of age (or such older age as may be specified in the policy) to produce on request, before being served alcohol, identification bearing their photograph, date of birth and either -
 - (a) a holographic mark, or
 - (b) an ultraviolet feature.

7. The responsible person must ensure that -
- (a) where any of the following alcoholic drinks is sold or supplied for consumption on the premises (other than alcoholic drinks sold or supplied having been made up in advance ready for sale or supply in a securely closed container) it is available to customers in the following measures -
 - (i) beer or cider: ½ pint;
 - (ii) gin, rum, vodka or whisky: 25 ml or 35 ml; and
 - (iii) still wine in a glass: 125 ml;
 - (b) these measures are displayed in a menu, price list or other printed material which is available to customers on the premises; and
 - (c) where a customer does not in relation to a sale of alcohol specify the quantity of alcohol to be sold, the customer is made aware that these measures are available.

A responsible person in relation to a licensed premises means the holder of the premises licence in respect of the premises, the designated premises supervisor (if any) or any individual aged 18 or over who is authorised by either the licence holder or designated premises supervisor. For premises with a club premises certificate, any member or officer of the club present on the premises in a capacity that which enables him to prevent the supply of alcohol.

8(i) A relevant person shall ensure that no alcohol is sold or supplied for consumption on or off the premises for a price which is less than the permitted price.

8(ii) For the purposes of the condition set out in paragraph 8(i) above -

- (a) "duty" is to be construed in accordance with the Alcoholic Liquor Duties Act 1979;
- (b) "permitted price" is the price found by applying the formula -

$$P = D + (D \times V)$$

Where -

- (i) P is the permitted price,
- (ii) D is the amount of duty chargeable in relation to the alcohol as if the duty were charged on the date of the sale or supply of the alcohol, and
- (iii) V is the rate of value added tax chargeable in relation to the alcohol as if the value added tax were charged on the date of the sale or supply of the alcohol;

(c) "relevant person" means, in relation to premises in respect of which there is in force a premises licence -

- (i) the holder of the premises licence,
- (ii) the designated premises supervisor (if any) in respect of such a licence, or
- (iii) the personal licence holder who makes or authorises a supply of alcohol under such a licence;

(d) "relevant person" means, in relation to premises in respect of which there is in force a club premises certificate, any member or officer of the club present on the premises in a capacity which enables the member or officer to prevent the supply in question; and

(e) "value added tax" means value added tax charged in accordance with the Value Added Tax Act 1994.

8(iii). Where the permitted price given by Paragraph 8(ii)(b) above would (apart from this paragraph) not be a whole number of pennies, the price given by that sub-paragraph shall be taken to be the price actually given by that sub-paragraph rounded up to the nearest penny.

8(iv). (1) Sub-paragraph 8(iv)(2) below applies where the permitted price given by Paragraph 8(ii)(b) above on a day ("the first day") would be different from the permitted price on the next day ("the second day") as a result of a change to the rate of duty or value added tax.

(2) The permitted price which would apply on the first day applies to sales or supplies of alcohol which take place before the expiry of the period of 14 days beginning on the second day.

Annex 2 – Conditions consistent with the operating Schedule

9. . The number of persons accommodated at any one time (excluding staff) shall not exceed

Ground Floor 90 persons

Basement 30 persons

Annex 3 – Conditions attached after a hearing by the licensing authority

10. The area hatched black on the deposited plans shall only operate as a restaurant,
- i) In which customers are shown to their table,
 - ii) Where the supply of alcohol is by waiter or waitress service only,
 - iii) Which provide food in the form of substantial table meals that are prepared on the premises and are served and consumed at the table using non disposable crockery,
 - iv) Which do not provide any take away service of food or drink for immediate consumption,
 - v) Which do not provide any take away service of food or drink after 23:00, and
 - vi) Where alcohol shall not be sold or supplied, otherwise than for consumption by persons who are seated in the premises and bona fide taking a substantial table meal there, and provided always that the consumption of alcohol by such persons is ancillary to taking such meals.

Notwithstanding this condition customers are permitted to take from the premises part consumed and resealed bottles of wine supplied ancillary to their meal.

11. No noise shall emanate from the premises nor vibration be transmitted through the structure of the premises which gives rise to a nuisance.
12. Substantial food and non-intoxicating beverages, including drinking water shall be available in all parts of the premises where alcohol is sold or supplied for consumption on the premises.
13. Notices shall be prominently displayed at all exits requesting patrons to respect the needs of local residents and businesses and leave the area quietly.
14. All waste shall be properly presented and placed out for collection no earlier than 30 minutes before the scheduled collection times.
15. No waste or recyclable materials, including bottles, shall be moved, removed from or placed in outside areas between 23:00 and 08:00 hours on the following day.
16. During the hours of operation of the premises, the licence holder shall ensure sufficient measures are in place to remove and prevent litter or waste arising or accumulating from customers in the area immediately outside the premises and that this area shall be swept and or washed and litter and sweeping collected and stored in accordance with the approved refuse storage arrangements by close of business.
17. There shall be no striptease or nudity, and all persons shall be decently attired at all times, except when the premises are operating under the authority of a sexual entertainment Venue Licence.
18. Patrons permitted to temporarily leave and then re-enter the premises, e.g. to smoke shall not be permitted to take drinks or glass containers with them.
19. The premises shall install and maintain a comprehensive CCTV system as per the minimum requirements of the Westminster Police Licensing Team. All entry and exit points will be covered enabling frontal identification of every person entering in any light condition. The CCTV system shall continually record whilst the premises is open for licensable activities and during all times when customers remain on the premises. All recordings shall be stored for a minimum period of 31 days with date and time stamping. Viewing of recordings shall be made available immediately upon the request of Police or authorised officer throughout the preceding 31 day period.
20. A staff member from the premises who is conversant with the operation of the CCTV system shall be on the premises at all times when the premises is open. This staff member

must be able to provide a Police or authorised council officer copies of recent CCTV images or data with the absolute minimum of delay when requested.

21. An incident log shall be kept at the premises, and made available on request to an authorised officer of the City Council or the Police, which will record the following:

- (a) all crimes reported to the venue
- (b) all ejections of patrons
- (c) any complaints received concerning crime and disorder
- (d) any incidents of disorder
- (e) all seizures of drugs or offensive weapons
- (f) any faults in the CCTV system or searching equipment or scanning equipment
- (g) any refusal of the sale of alcohol
- (h) any visit by a relevant authority or emergency service.

22. No deliveries to the premises shall take place between 23.00 and 08.00 on the following day.

Annex 4 – Plans

Attached



City of Westminster
64 Victoria Street, London, SW1E 6QP

Schedule 12
Part B

WARD: St James's
UPRN: 010033551344

Premises licence
summary

Regulation 33, 34

Premises licence number:

23/09243/LIPDPS

Part 1 – Premises details

Postal address of premises:

Frenchie
Basement And Ground Floor
16 Henrietta Street
London
WC2E 8QH

Telephone Number: Not Supplied

Where the licence is time limited, the dates:

Not applicable

Licensable activities authorised by the licence:

Playing of Recorded Music
Late Night Refreshment
Sale by Retail of Alcohol

The times the licence authorises the carrying out of licensable activities:

Playing of Recorded Music

Monday to Saturday: 23:00 to 00:30
Sunday: 23:00 to 00:00

Non-standard Timings: From the end of permitted hours on New Year's Eve to the start of permitted hours on New Year's Day.

Late Night Refreshment

Monday to Saturday: 23:00 to 00:30
Sunday: 23:00 to 00:00

Non-standard Timings: From the end of permitted hours on New Year's Eve to the start of permitted hours on New Year's Day.

Sale by Retail of Alcohol

Monday to Saturday: 10:00 to 00:00
Sunday: 12:00 to 23:30

Non-standard Timings: From the end of permitted hours on New Year's Eve to the start of permitted hours on New Year's Day.

For times authorised for Christmas, New Year and Good Friday see conditions at Annex 1

The opening hours of the premises:

Monday to Saturday: 10:00 to 00:30
Sunday: 12:00 to 00:00

Where the licence authorises supplies of alcohol, whether these are on and/or off supplies:

Alcohol is supplied for consumption both on and off the Premises.

Name and (registered) address of holder of premises licence:

Frenchie London Ltd
C/O Pbsl
First Floor
42 Sydenham Road
London
United Kingdom
SE26 5QF

Registered number of holder, for example company number, charity number (where applicable)

09627718

Name of designated premises supervisor where the premises licence authorises for the supply of alcohol:

Name: Ben Wesley Matthews

State whether access to the premises by children is restricted or prohibited:

Restricted

Date: 11th January 2024

Signed:



pp

This licence has been authorised by Karyn Abbott on behalf of the Director - Environment, Climate & Public Protection (ECPP).

Appendix 4

CONDITIONS CONSISTENT WITH THE OPERATING SCHEDULE AND CONDITIONS PROPOSED BY A PARTY TO THE HEARING

When determining an application for a new premises licence under the provisions of the Licensing Act 2003, the licensing authority must, unless it decides to reject the application, grant the licence subject to the conditions which are indicated as mandatory in this schedule.

At a hearing the licensing authority may, in addition, and having regard to any representations received, grant the licence subject to such conditions which are consistent with the operating schedule submitted by the applicant as part of their application, or alter or omit these conditions, or add any new condition to such extent as the licensing authority considers necessary for the promotion of the licensing objectives.

This schedule lists those conditions which are consistent with the operating schedule, or proposed as necessary for the promotion of the licensing objectives by a responsible authority or an interested party as indicated. These conditions have not been submitted by the licensing service but reflect the positions of the applicant, responsible authority or interested party and have not necessarily been agreed

Mandatory Conditions

1. No supply of alcohol may be made at a time when there is no designated premises supervisor in respect of this licence.
2. No supply of alcohol may be made at a time when the designated premises supervisor does not hold a personal licence or the personal licence is suspended.
3. Every supply of alcohol under this licence must be made or authorised by a person who holds a personal licence.
4.
 - (1) The responsible person must ensure that staff on relevant premises do not carry out, arrange or participate in any irresponsible promotions in relation to the premises.
 - (2) In this paragraph, an irresponsible promotion means any one or more of the following activities, or substantially similar activities, carried on for the purpose of encouraging the sale or supply of alcohol for consumption on the premises—
 - (a) games or other activities which require or encourage, or are designed to require or encourage, individuals to;
 - (i) drink a quantity of alcohol within a time limit (other than to drink alcohol sold or supplied on the premises before the cessation of the period in which the responsible person is authorised to sell or supply alcohol), or
 - (ii) drink as much alcohol as possible (whether within a time limit or otherwise);
 - (b) provision of unlimited or unspecified quantities of alcohol free or for a fixed or discounted fee to the public or to a group defined by a particular characteristic in a manner which carries a significant risk of undermining a licensing objective;
 - (c) provision of free or discounted alcohol or any other thing as a prize to encourage or reward the purchase and consumption of alcohol over a period of 24 hours or

less in a manner which carries a significant risk of undermining a licensing objective;

- (d) selling or supplying alcohol in association with promotional posters or flyers on, or in the vicinity of, the premises which can reasonably be considered to condone, encourage or glamorise anti-social behaviour or to refer to the effects of drunkenness in any favourable manner;
 - (e) dispensing alcohol directly by one person into the mouth of another (other than where that other person is unable to drink without assistance by reason of a disability).
5. The responsible person must ensure that free potable water is provided on request to customers where it is reasonably available.
6. (1) The premises licence holder or club premises certificate holder must ensure that an age verification policy is adopted in respect of the premises in relation to the sale or supply of alcohol.
- (2) The designated premises supervisor in relation to the premises licence must ensure that the supply of alcohol at the premises is carried on in accordance with the age verification policy.
- (3) The policy must require individuals who appear to the responsible person to be under 18 years of age (or such older age as may be specified in the policy) to produce on request, before being served alcohol, identification bearing their photograph, date of birth and either—
- (a) a holographic mark, or
 - (b) an ultraviolet feature.
7. The responsible person must ensure that—
- (a) where any of the following alcoholic drinks is sold or supplied for consumption on the premises (other than alcoholic drinks sold or supplied having been made up in advance ready for sale or supply in a securely closed container) it is available to customers in the following measures—
 - (i) beer or cider: ½ pint;
 - (ii) gin, rum, vodka or whisky: 25 ml or 35 ml; and
 - (iii) still wine in a glass: 125 ml;
 - (b) these measures are displayed in a menu, price list or other printed material which is available to customers on the premises; and
 - (c) where a customer does not in relation to a sale of alcohol specify the quantity of alcohol to be sold, the customer is made aware that these measures are available.

A responsible person in relation to a licensed premises means the holder of the premise licence in respect of the premises, the designated premises supervisor (if any) or any individual aged 18 or over who is authorised by either the licence holder or designated premises supervisor. For premises with a club premises certificate, any member or officer of the club present on the premises in a capacity that which enables him to prevent the supply of alcohol.

8(i) A relevant person shall ensure that no alcohol is sold or supplied for consumption on or off the premises for a price which is less than the permitted price.

8(ii) For the purposes of the condition set out in paragraph 8(i) above -

(a) "duty" is to be construed in accordance with the Alcoholic Liquor Duties Act 1979;

(b) "permitted price" is the price found by applying the formula -

$$P = D + (D \times V)$$

Where -

(i) P is the permitted price,

(ii) D is the amount of duty chargeable in relation to the alcohol as if the duty were charged on the date of the sale or supply of the alcohol, and

(iii) V is the rate of value added tax chargeable in relation to the alcohol as if the value added tax were charged on the date of the sale or supply of the alcohol;

(c) "relevant person" means, in relation to premises in respect of which there is in force a premises licence -

(i) the holder of the premises licence,

(ii) the designated premises supervisor (if any) in respect of such a licence, or

(iii) the personal licence holder who makes or authorises a supply of alcohol under such a licence;

(d) "relevant person" means, in relation to premises in respect of which there is in force a club premises certificate, any member or officer of the club present on the premises in a capacity which enables the member or officer to prevent the supply in question; and

(e) "value added tax" means value added tax charged in accordance with the Value Added Tax Act 1994.

8(iii). Where the permitted price given by Paragraph 8(ii)(b) above would (apart from this paragraph) not be a whole number of pennies, the price given by that sub-paragraph shall be taken to be the price actually given by that sub-paragraph rounded up to the nearest penny.

8(iv). (1) Sub-paragraph 8(iv)(2) below applies where the permitted price given by Paragraph 8(ii)(b) above on a day ("the first day") would be different from the permitted price on the next day ("the second day") as a result of a change to the rate of duty or value added tax.

(2) The permitted price which would apply on the first day applies to sales or supplies of alcohol which take place before the expiry of the period of 14 days beginning on the second day.

Conditions consistent with the operating schedule

9. The number of persons accommodated at any one time (excluding staff) shall not exceed:
Ground Floor 90 persons
Basement 30 persons
10. The area hatched black on the deposited plans shall only operate as a restaurant,
 - i) In which customers are shown to their table,
 - ii) Where the supply of alcohol is by waiter or waitress service only,
 - iii) Which provide food in the form of substantial table meals that are prepared on the premises and are served and consumed at the table using non disposable crockery,
 - iv) Which do not provide any take away service of food or drink for immediate consumption,
 - v) Which do not provide any take away service of food or drink after 23:00, and
 - vi) Where alcohol shall not be sold or supplied, otherwise than for consumption by persons who are seated in the premises and bona fide taking a substantial table meal there, and provided always that the consumption of alcohol by such persons is ancillary to taking such meals.

Notwithstanding this condition customers are permitted to take from the premises part consumed and resealed bottles of wine supplied ancillary to their meal.

11. No noise shall emanate from the premises nor vibration be transmitted through the structure of the premises which gives rise to a nuisance.
12. Substantial food and non-intoxicating beverages, including drinking water shall be available in all parts of the premises where alcohol is sold or supplied for consumption on the premises.
13. Notices shall be prominently displayed at all exits requesting patrons to respect the needs of local residents and businesses and leave the area quietly.
14. All waste shall be properly presented and placed out for collection no earlier than 30 minutes before the scheduled collection times.
15. No waste or recyclable materials, including bottles, shall be moved, removed from or placed in outside areas between 23:00 and 08:00 hours on the following day.
16. During the hours of operation of the premises, the licence holder shall ensure sufficient measures are in place to remove and prevent litter or waste arising or accumulating from customers in the area immediately outside the premises and that this area shall be swept and or washed and litter and sweeping collected and stored in accordance with the approved refuse storage arrangements by close of business.
17. There shall be no striptease or nudity, and all persons shall be decently attired at all times, except when the premises are operating under the authority of a sexual entertainment Venue Licence.
18. Patrons permitted to temporarily leave and then re-enter the premises, e.g. to smoke shall not be permitted to take drinks or glass containers with them.
19. The premises shall install and maintain a comprehensive CCTV system as per the minimum requirements of the Westminster Police Licensing Team. All entry and exit points will be covered enabling frontal identification of every person entering in any light

condition. The CCTV system shall continually record whilst the premises is open for licensable activities and during all times when customers remain on the premises. All recordings shall be stored for a minimum period of 31 days with date and time stamping. Viewing of recordings shall be made available immediately upon the request of Police or authorised officer throughout the preceding 31 day period.

20. A staff member from the premises who is conversant with the operation of the CCTV system shall be on the premises at all times when the premises is open. This staff member must be able to provide a Police or authorised council officer copies of recent CCTV images or data with the absolute minimum of delay when requested.
21. An incident log shall be kept at the premises, and made available on request to an authorised officer of the City Council or the Police, which will record the following:
 - (a) all crimes reported to the venue
 - (b) all ejections of patrons
 - (c) any complaints received concerning crime and disorder
 - (d) any incidents of disorder
 - (e) all seizures of drugs or offensive weapons
 - (f) any faults in the CCTV system or searching equipment or scanning equipment
 - (g) any refusal of the sale of alcohol
 - (h) any visit by a relevant authority or emergency service.
22. No deliveries to the premises shall take place between 23.00 and 08.00 on the following day.

16 HENRIETTA STREET, LONDON, WC2E 8QH

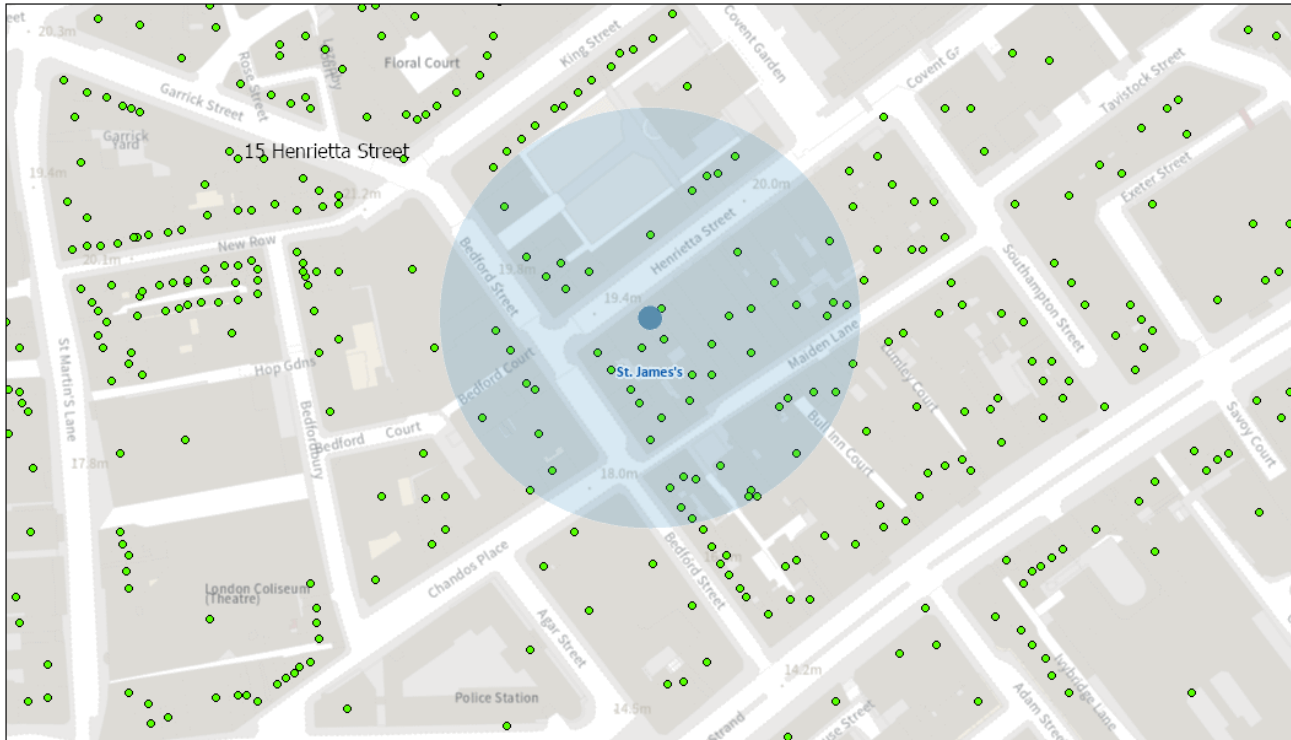

26/04/2024, 11:33:12

- Property Mailing List
- Ward Boundaries
- Ward Labels

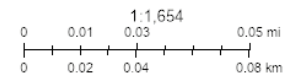

Resident Count: 79

Licensed premises within 75m of 16 Henrietta Street				
Licence Number	Trading Name	Address	Premises Type	Time Period
24/00291/LIPDPS	Henrietta Street Hotel	15 Henrietta Street London WC2E 8QG	Hotel, 3 star or under	Monday to Sunday; 00:00 - 00:00
23/01913/LIPCH	Flat Iron	17 - 18 Henrietta Street London WC2E 8QH	Restaurant	Sunday; 12:00 - 00:00 Monday to Saturday; 10:00 - 00:30
21/10712/PREAPS	Not Recorded	19 Henrietta Street London WC2E 8QH	Not Recorded	

24/01266/LIPDPS	All Bar One	Ground Floor And Basement 19 Henrietta Street London WC2E 8QH	Public house or pub restaurant	Sunday; 08:00 - 22:50 Monday to Thursday; 08:00 - 23:30 Friday to Saturday; 08:00 - 00:00 Sundays before Bank Holidays; 08:00 - 00:00
21/02120/LIPDPS	Cinnamon (First Second Floors)	28 Maiden Lane London WC2E 7JS	Restaurant	Sunday; 10:00 - 23:00 Monday to Thursday; 10:00 - 00:00 Friday to Saturday; 10:00 - 00:30 Sundays before Bank Holidays; 12:00 - 00:00
21/02130/LIPDPS	Cinnamon (Basement Ground Floor)	28 Maiden Lane London WC2E 7JS	Restaurant	Sunday; 12:00 - 00:00 Monday to Saturday; 10:00 - 00:30
23/04518/LIPN	Not Recorded	37 Bedford Street London WC2E 9EN	Restaurant	Sunday; 09:00 - 22:30 Tuesday to Thursday; 09:00 - 23:30 Friday to Saturday; 09:00 - 00:00
23/08961/LIPDPS	Bar Du Champagne	23 - 24 Henrietta Street London WC2E 8ND	Not Recorded	Sunday; 08:00 - 23:00 Monday to Saturday; 08:00 - 23:30
22/07221/LIPCH	Shadow Licence	23 - 24 Henrietta Street London WC2E 8ND	Premises Licence - Shadow Licence	Monday; 08:00 - 23:30 Tuesday; 08:00 - 23:30 Wednesday; 08:00 - 23:30 Thursday; 08:00 - 23:30 Friday; 08:00 - 23:30 Saturday; 08:00 - 23:30 Sunday; 08:00 - 23:00
22/02979/LIPN	Not Recorded	28 Henrietta Street London WC2E 8NA	Shop (large)	Monday; 08:00 - 23:00 Tuesday; 08:00 - 23:00 Wednesday; 08:00 - 23:00 Thursday; 08:00 - 23:00 Friday; 08:00 - 23:00 Saturday; 08:00 - 23:00 Sunday; 09:00 - 22:30

21/07735/LIPVM	Ave Mario - 15 Henrietta Street &	29 - 30 Maiden Lane London WC2E 7JS	Restaurant	Monday; 08:00 - 01:00 Tuesday; 08:00 - 01:00 Wednesday; 08:00 - 01:30 Thursday; 08:00 - 01:30 Friday; 08:00 - 01:30 Saturday; 08:00 - 01:30 Sunday; 08:00 - 01:00
23/01310/LIPDPS	The Lowdown	Basement And Ground Floor 38 Bedford Street London WC2E 9EU	Restaurant	Monday; 08:00 - 23:00 Tuesday; 08:00 - 23:00 Wednesday; 08:00 - 23:00 Thursday; 08:00 - 23:00 Friday; 08:00 - 23:00 Saturday; 08:00 - 23:00 Sunday; 08:00 - 23:00
22/11842/LIPDPS	Sticks n Sushi	11 Henrietta Street London WC2E 8PY	Restaurant	Sunday; 12:00 - 22:50 Monday to Thursday; 10:00 - 00:00 Friday to Saturday; 10:00 - 00:30
20/05529/LIPN	(Shadow Licence)	11 Henrietta Street London WC2E 8PY	Premises Licence - Shadow Licence	Sunday; 12:00 - 22:50 Monday to Thursday; 10:00 - 00:00 Friday to Saturday; 10:00 - 00:30
21/09338/LIPN	Benihana	31 - 32 Maiden Lane London WC2E 7JS	Restaurant	Sunday; 10:00 - 00:00 Monday to Saturday; 10:00 - 01:00
24/02431/LIPCH	Not Recorded	Basement And Ground Floor 10 Henrietta Street London WC2E 8PS	Restaurant	Sunday; 12:00 - 22:03 Monday to Thursday; 10:00 - 23:03 Friday to Saturday; 10:00 - 00:00

22/02158/LIPT	Oystermen	33 Bedford Street London WC2E 9ED	Wine bar	Monday; 09:00 - 23:30 Tuesday; 09:00 - 23:30 Wednesday; 09:00 - 23:30 Thursday; 09:00 - 23:30 Friday; 09:00 - 00:00 Saturday; 09:00 - 00:00 Sunday; 09:00 - 22:30
24/00809/LIPDPS	Z Hotel	31 - 32 Bedford Street London WC2E 9ED	Hotel, 4+ star or major chain	Monday to Sunday; 07:00 - 23:00
24/01503/LIPDPS	Henrietta Hotel - Bedrooms	30 - 33 Henrietta Street London WC2E 8LH	Hotel, 4+ star or major chain	Monday to Sunday; 00:00 - 00:00
20/01464/LIPV	Cora Pearl	30 Henrietta Street London WC2E 8NA	Restaurant	Monday; 10:00 - 01:00 Tuesday; 10:00 - 01:00 Wednesday; 10:00 - 01:00 Thursday; 10:00 - 01:00 Friday; 10:00 - 01:00 Saturday; 10:00 - 01:00 Sunday; 12:00 - 00:00
22/00675/LIPDPS	Unit 2	15 Bedford Street London WC2E 9HE	Restaurant	Monday; 10:00 - 23:30 Tuesday; 10:00 - 23:30 Wednesday; 10:00 - 23:30 Thursday; 10:00 - 23:30 Friday; 10:00 - 00:00 Saturday; 10:00 - 00:00 Sunday; 12:00 - 22:30
19/08907/LIPN	Unit 2	15 Bedford Street London WC2E 9HE	Restaurant	Monday; 10:00 - 23:30 Tuesday; 10:00 - 23:30 Wednesday; 10:00 - 23:30 Thursday; 10:00 - 23:30 Friday; 10:00 - 00:00 Saturday; 10:00 - 00:00 Sunday; 12:00 - 22:30

21/12430/LIPD	Pasta Brown	31 Bedford Street London WC2E 9EH	Cafe	Sunday; 12:00 - 00:00 Monday to Saturday; 10:00 - 00:30
24/00952/LIPDPS	Wagamama	17 Bedford Street London WC2E 9HP	Restaurant	Sunday; 09:30 - 23:00 Monday to Saturday; 09:00 - 00:00
17/08902/LIPN	Host Coffee	31 Henrietta Street London WC2E 8NA	Cafe	Saturday; 08:30 - 22:00 Sunday; 10:00 - 19:00 Monday to Wednesday; 07:30 - 21:00 Thursday to Friday; 07:30 - 22:00
18/13136/LIPRW	Rules Restaurant	34 - 35 Maiden Lane London WC2E 7LB	Restaurant	Monday; 10:00 - 00:30 Tuesday; 10:00 - 00:30 Wednesday; 10:00 - 00:30 Thursday; 10:00 - 00:30 Friday; 10:00 - 00:30 Saturday; 10:00 - 00:30 Sunday; 12:00 - 00:00
18/08785/LIPN	Oystermen	31 - 32 Henrietta Street London WC2E 8NA	Restaurant	Sunday; 10:00 - 22:30 Monday to Thursday; 08:00 - 23:30 Friday to Saturday; 08:00 - 00:00
18/09935/LIPV	Lady Of The Grapes	16 Maiden Lane London WC2E 7NJ	Restaurant	Sunday; 12:00 - 00:00 Monday to Saturday; 10:00 - 00:30
23/02851/LIPT	Ping Pong	23 - 24 Maiden Lane London WC2E 7NP	Restaurant	Sunday; 12:00 - 00:00 Monday to Saturday; 10:00 - 00:30
14/06782/LIPVM	The Porterhouse Public House	21 - 22 Maiden Lane London WC2E 7NA	Restaurant	Sunday; 12:00 - 23:00 Monday to Saturday; 09:00 - 00:30

20/04724/LIPV	Condesa Tapas Bar	15 Maiden Lane London WC2E 7NG	Cafe	Sunday; 10:00 - 22:00 Friday to Saturday; 10:00 - 23:30 Sunday to Thursday; 10:00 - 23:00 Sundays before Bank Holidays; 12:00 - 00:00
22/09223/LIPDPS	Nandos	67 - 68 Chandos Place London WC2N 4HG	Restaurant	Not Recorded; XXXX - XXXX
19/06487/LIPDPS	Paul Patisserie	Ground Floor Inigo House 29 Bedford Street London WC2E 9ED	Shop	Sunday; 09:00 - 23:00 Monday to Saturday; 07:30 - 23:30
17/10013/LIPDPS	Masons Cafe Bar	Basement And Ground Floor 5 - 6 Henrietta Street London WC2E 8PT	Restaurant	Sunday; 09:00 - 23:30 Monday to Saturday; 07:30 - 00:00
21/13571/LIPDPS	Din Tai Fung	5 - 6 Henrietta Street London WC2E 8PS	Not Recorded	Monday to Sunday; 11:00 - 00:00
22/05368/LIPDPS	Adelphi Theatre	411 Strand London WC2R 0NS	Theatre	Monday to Friday; 09:00 - 04:00 Saturday to Sunday; 09:00 - 00:00
23/08867/LIPDPS	Gordon Ramsay Street Burger	Ground Floor 13 - 14 Maiden Lane London WC2E 7NE	Restaurant	Sunday; 12:00 - 22:30 Monday to Thursday; 10:00 - 23:30 Friday to Saturday; 10:00 - 00:00
23/00897/LIPDPS	Wahaca	66 Chandos Place London WC2N 4HG	Restaurant	Sunday; 10:00 - 00:00 Monday to Saturday; 10:00 - 00:30